

# **INSTALL INSTRUCTIONS**

**2015 F-150 Brushguard**

**Product : 615BRSH**

**Application : 2015 Ford F-150**

**⚠ WARNING**

Read the instructions completely before beginning installation. Before tightening bolts, drilling or cutting where required, check to make sure there are no obstructions such as brake, fuel or electrical lines which may be damaged. Also keep in mind this is an after-market product and MAY require minor shimming and/or trimming, reaming, etc. for proper fit. Road Armor is not responsible for any damages to vehicle.

**❗ IMPORTANT NOTICE**

- Be sure to inspect and test fit your product to ensure proper fitment before having it coated, painted, bed lined, etc.
- Road Armor will not be responsible for the cost of coating your unit if any problems with fit or finish are not noted and addressed beforehand.

## SAFETY FIRST!

- FOLLOW ALL INSTRUCTIONS, YOUR SAFETY AND THE SAFETY OF OTHERS IS MOST IMPORTANT.
- WEAR APPROPRIATE EYE PROTECTION AND EXERCISE CAUTION WHEN DRILLING / CUTTING

## REQUIRED TOOLS

Socket Set

Wrenches

## INCLUDED HARDWARE

9x) 1/2-inch Grade 8 Bolts

18x) Washers

9x) Lock Washers and Nuts

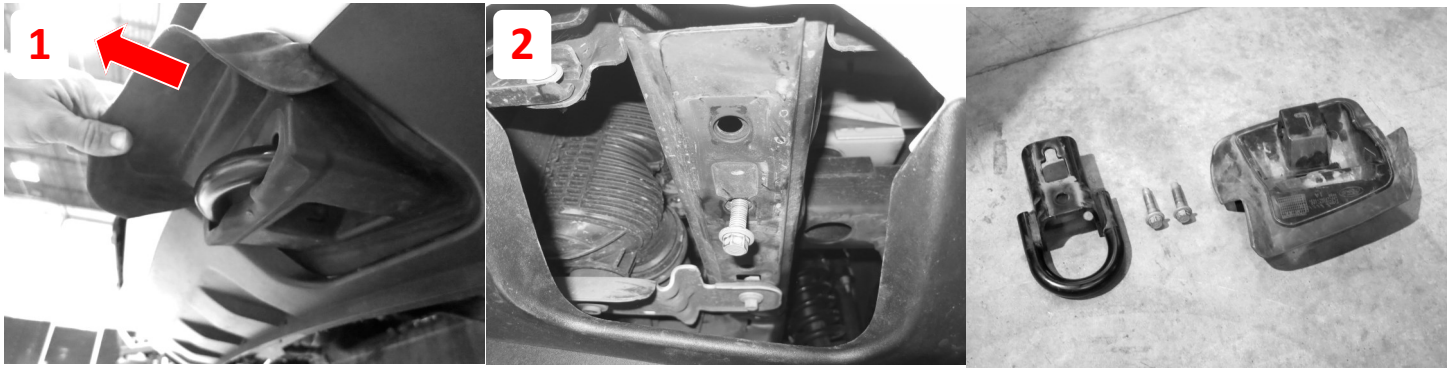

- 1** Remove the rubber shroud from tow hook pulling forward. This takes some force.
- 2** Remove front bolt from tow hook, then rear bolt. The tow hook will slide off once the rear is loose.
- 3** Brackets install as shown. Passenger on Left, Driver on Right.
- 4** Fit up bracket to Driver side. Install rear bolt first, then slide on tow hook.
- 5** Install forward bolt next then snug but don't fully tighten to allow adjustment.
- 6** Repeat for Passenger side.

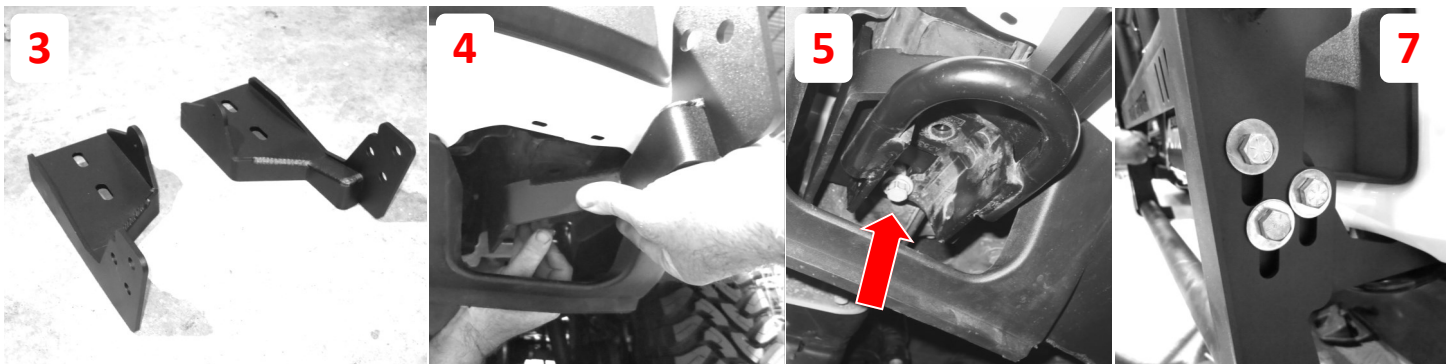

- 7** Fit up brush / grille guard to outside of brackets then install all hardware as shown.

**NOTE**

Do not fully tighten any hardware until satisfied with fitment.

- 8** The brush guard will have rotational, up / down and side to side adjustment still. Center it and check headlight reveal then begin by tightening the tow hooks, then the top bolt on either side of the brush guard.
- 9** Congratulations! All done. If you have lights to install, now would be the time.

